



INSTRUCTION MANUAL
 Battery Charger
 Model Number 1232547



115V

 <p>CU 72170135 01 File # 17062442 001</p>	<p>Powered by</p>  <p>Tel: 1-800-553-8033</p>	 <p>The device is only suitable for indoor use; do not expose the device to rain.</p>	 <p>Read these instructions before using the Battery Charger.</p>	 <p>Read these Safety Instructions before operating the Battery Charger.</p>
<p>The operator needs to be at least 18 years old.</p>				

THANK YOU FOR CHOOSING THE i-mop BATTERY CHARGER

Please read the manual carefully for important safety information and operating instructions before using the Battery Charger. Keep this manual for future reference because it contains important information.

TABLE OF CONTENTS

- P. 02 Product Description
- P. 02 Function
- P. 02 Copy of Rating Plate
- P. 03 Safety Instructions
- P. 04 Health Hazards
- P. 04 First Aid Measures
- P. 04 Contents
- P. 04 Voltage Indication
- P. 05 Initial Setup
- P. 06 Technical Data
- P. 06 Recycling and Disposal
- P. 06 Declarations
- P. 06 Warranty
- P. 07 Troubleshooting
- P. 07 Exploded View
- P. 08 Key for Exploded View

COPY OF RATING PLATE:

i-team North America 

Item No.: 1232547 | S.72.0299.0/A

Input :
AC 100-240V 1-2.3A MAX 50-60Hz, Class 2

Output :
DC 29V 2Ax2 (Each Output 2A)

Fuse:  6.3A/300ms

Serial No.:
Made in: PRC

Before charging, read the instructions.
avant le chargement, lisez les instructions.
CAUTION: FOR INDOOR ONLY
attention: pour une utilisation à l'intérieur

Backfeed Protection
WARNING: Risk of Fire or Electric Shock.
Do not interconnect output terminations.
Refer to the instruction manual for the size, type, and number of batteries to be charged.
CAUTION: Risk of Electric Shock.
Dry location use only. Do not expose to liquid, vapor, or rain.

RÉTROACTION DE PROTECTION
Avertissement: un incendie ou un risque de choc électrique. Pas de connexion de la borne de sortie. Veuillez consulter la notice de type, de taille, de la batterie et de la quantité de charge.

AVERTISSEMENT:
un risque de choc électrique. Un endroit sec utilisé. Pas d'exposition au liquide, de la vapeur ou de la pluie.

Dongguan Victory Battery Technology Co., LTD

Serial No.: 17175001

YEAR | JULIAN DATE | CONSECUTIVE NUMBER

PRODUCT DESCRIPTION

Product Identification

Product Name: Battery Charger

Model Number: 1232547

FUNCTION

The Battery Charger is designed only to charge the i-mop Li-Ion batteries.

Battery Specifications:

Battery Mode: Lithium-Ion Battery
1232100

Rated Capacity: 8.8~14AH

Quantity: 2 PCS.

TESTS PERFORMED:

1. The submitted samples were tested and found to comply with the requirements of standards.
2. Constructions of all alternative components are considered and evaluated in this report.

TESTS LOCATION:

TÜV Rheinland (Guangdong) Ltd.
No. 199 Kezhu Road, Guangzhou Science City 510663
Guangzhou, China

GENERAL PRODUCT INFORMATION:

The products covered by this report is a Class 2 Battery Charger for indoor use only, provided with a detachable flexible power supply cord terminated in a recognized 3-wire grounding type plug intended to charge maximum capacity of 14 AH Li-Ion battery.

Rating of Model 1232547:

INPUT: AC100V-240V, 1-2.3A MAX, 50-60Hz

OUTPUT: DC29V, 2A x 2 (each output 2A)

NOTE: There are two output channels, each output rated 2.0A and totaling 4.0A

SAFETY INSTRUCTIONS

Your safety, and safety of others is important. Operating this Battery Charger safely is an important responsibility. In addition to the information contained in this Instruction Manual, all statutory safety and accident prevention regulations must be observed.

Do Not Operate the Battery Charger:

- Unless you have read and understood this Instruction Manual.
- Near flammable dusts, liquids or vapors.
- Near flammable liquids like gasoline, oil, acids, or other volatile substances.
- Outdoors or in explosive environment.
- If it is dirty or wet.
- Over electrical floor outlets, to avoid electric shock.
- If any parts have been damaged or removed.
- If you are younger than 18 years old.



DANGER

Flammable materials can cause an explosion or fire.



WARNING

Do not remove, paint over or destroy warning decals.
Read all these warnings before using the Battery Charger.



CAUTION!

- Charge only original i-mop Lithium-Ion (Li-Ion) battery packs – other types of batteries may burst causing personal injury and damage.
- Check the power cord regularly for any sign of damage.
- Do not use the charger in a closed cabinet. Use only in a ventilated space.
- Do not use a damaged Battery Charger.
- If the power cord of the charger is damaged, it must be replaced by a manufacturer-supplied Battery Charger cord.
- Protect the Battery Charger against moisture and store in a dry place.
- The device is only suitable for indoor use. Do not use it outdoors.
- Do not use the Battery Charger if it is wet.
- Do not expose the Battery Charger to rain.
- Do not charge in temperatures below 0°C / 32°F.
- The main voltage available must correspond to the voltage stated on the rating plate of the Battery Charger.
- Do not operate the Battery Charger in an explosive environment.
- Do not carry the Battery Charger by holding the power cord.
- Do not handle the electrical cord or plug it into an outlet if hands are wet.
- Do not unplug by pulling on cord. To unplug, grasp the plug, not the cord.
- Do not cover the Battery Charger while in use.
- Do not open the Battery Charger. Repairs should be done only by manufacturer-authorized personnel.
- Do not charge damaged battery packs.
- Do not charge the battery packs if they are wet – charge dry battery packs only.
- Do not charge non-rechargeable battery packs in this Battery Charger.
- Do not leave battery packs on Battery Charger. Remove when fully charged to avoid self-discharge.



Health Hazards

- The chemicals used in the battery are in a sealed container.
- Risk of battery chemical exposure only occurs if the battery is abused or damaged.
- Contact of electrolyte and lithium with skin and eyes should be avoided.
- A damaged or leaking battery can cause chemical burns upon contact.

First Aid Measures

If exposed to any of the battery chemicals, please follow the procedures below:

Eyes

- Flush eyes with plenty of water for at least 15 minutes, occasionally lifting the upper and lower eyelid.
- Seek medical attention.



Inhalation

- Vacate from site of exposure to fresh air immediately. Use oxygen if available.
- Seek medical attention.

Ingestion

- Give at least two glasses of milk or water. Induce vomiting unless patient is unconscious.
- Seek medical attention.

CONTENTS

1		1232547	1 x Battery Charger
2		1232546	1 x Power Cord
3			1 x Manual

Please make sure no items are missing by checking the contents against the above list. If one of the parts listed is missing, please contact your i-mop dealer.

VOLTAGE INDICATION

- LCD display calibrates charge as a percentage of capacity.
- Working range is 23~29.3 Volts (= 0-100%).
- If voltage is at 0%, it will not power the i-mop and must be recharged.
- If battery voltage is below 40%, it is recommended to recharge to 100% before warning.

Battery packs should be removed from the machine when not in use for more than 2 days to prevent damage to the battery's life cycle from self-discharge.

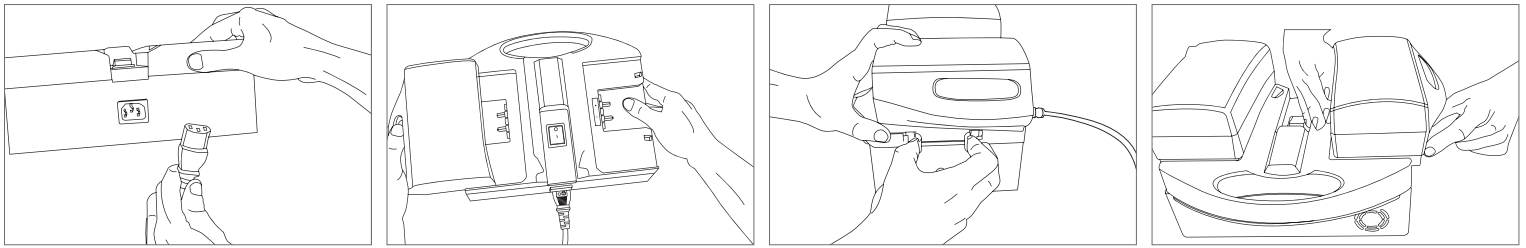

INITIAL SETUP

Plug the supplied power cord into the Battery Charger before it is plugged into an outlet.

Charging Battery Packs:

Connect AC power supply when green switch is off, turn on the green switch, and then connect the battery packs. Please follow the operation sequence carefully!

- Universal Input: 100~240 50/60Hz
- Output Short-Circuit Protect Function. (In standby mode, output voltage shall be 0V. It also prevents electric shock when battery packs are connected to charger.)
- When the red LED light and the LCD screen flash quickly, it indicates that the battery pack is completely discharged. It will attempt an initial charge for 2-5 minutes. If it keeps blinking it indicates battery pack failure and that the battery pack can no longer be recharged.

If after 3 minutes of rapid charging, the battery pack voltage can't reach at least 21.0V (3V/cell), the charge will be terminated and the red LED 2Hz light will quickly flash.

- The charger is designed so that battery packs cannot be inserted with the polarity reversed.
- The charger LCD screen will display charge status and battery pack voltage and capacity.
- When the charge current drops to 300mA, the battery pack is fully-charged. The green LED light will turn ON, the LCD screen will display the fully charged status, and the charging current will turn OFF.
- The charger will prevent the battery pack from slowly discharging when the charger does not have AC Input Power.
- When a fully charged battery pack is left in the charging stand for a prolonged period, and if the battery pack voltage drops to 28.0V, the charger will automatic recharge the battery pack.
- During rapid charging status, if the LED light turns off and the LCD screen stops running, the Battery Management System has determined that the battery pack is full charged even if the display did not register 100%.

LED Display

Charger Stage	DOUBLE COLOR LED	
	RED	GREEN
Power ON	OFF	OFF
Rapid Change	1Hz Flash	OFF
Fully Charged	OFF	ON
Battery Failure	Quickly Flash	OFF

LCD Display

With Battery Capacity and Charge Dynamic symbols:

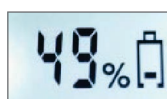

TECHNICAL DATA

DIMENSIONS (L X W X H)	8.9" x 10.4" x 4.3"
INPUT	AC 100~240V 1-2.3A MAX 50-60Hz, Class 2
OUTPUT	DC 29V 2Ax2 (Each Output 2A)
WEIGHT	2.6 lbs.
PACKING DIMENSIONS (L X W X H)	13.7" x 12.3" x 5.1"

ENVIRONMENT PROTECTION



The packaging materials can be recycled. Please do not throw the packaging material into household waste. Please recycle it.

Old devices contain valuable materials that can be recycled.



Rechargeable battery packs contain materials that should not be disposed of in landfills. Please dispose of old devices and battery packs and that they must be disposed of through suitable waste collection systems.

DECLARATIONS

UL Declaration

We hereby declare that this i-mop Battery Charger complies with the relevant basic safety and health requirements of UL standard, both in its basic design and construction as well as in the version put into circulation by us. This declaration shall cease to be valid if the machine is modified without our prior approval.

CSA Declaration

We hereby declare that this i-mop Battery Charger complies with the relevant basic safety and health requirements of CSA standard, both in its basic design and construction as well as in the version put into circulation by us. This declaration shall cease to be valid if the machine is modified without our prior approval.

CEC Declaration

We hereby declare that this i-mop Battery Charger complies with the relevant basic safety and health requirements of CEC standard, both in its basic design and construction as well as in the version put into circulation by us. This declaration shall cease to be valid if the machine is modified without our prior approval.

NOM Declaration

We hereby declare that this i-mop Battery Charger complies with the relevant basic safety and health requirements of NOM standard, both in its basic design and construction as well as in the version put into circulation by us. This declaration shall cease to be valid if the machine is modified without our prior approval.

Declaration Of Conformity

Future Cleaning Technologies B.V., Hoppenkuil 27b, 5626DD Eindhoven, The Netherlands
Distributed and Serviced by Tennant Company.

WARRANTY

The warranty terms published by Tennant are applicable in each country.

TROUBLESHOOTING

PROBLEMS		REMEDIES
1	NO RESPONSE, NO LIGHT ON.	<ol style="list-style-type: none"> 1. Check that the power cord is properly inserted and has power. 2. Check the Battery Charger and make sure the power switch is in the ON position (I) and confirm that the green light is on. 3. Check the fuse. Replace the fuse if it is found damaged. 4. Switch the main ON/OFF button.
2	RED LED KEEPS FLASHING.	<p>This happens if the voltage of the battery is too low (0~5 Volts).The red LED will keep flashing for a couple of minutes before it becomes steady.This will not affect re-charging the battery. The LED will turn green when the battery is fully charged.</p>

EXPLODED VIEW

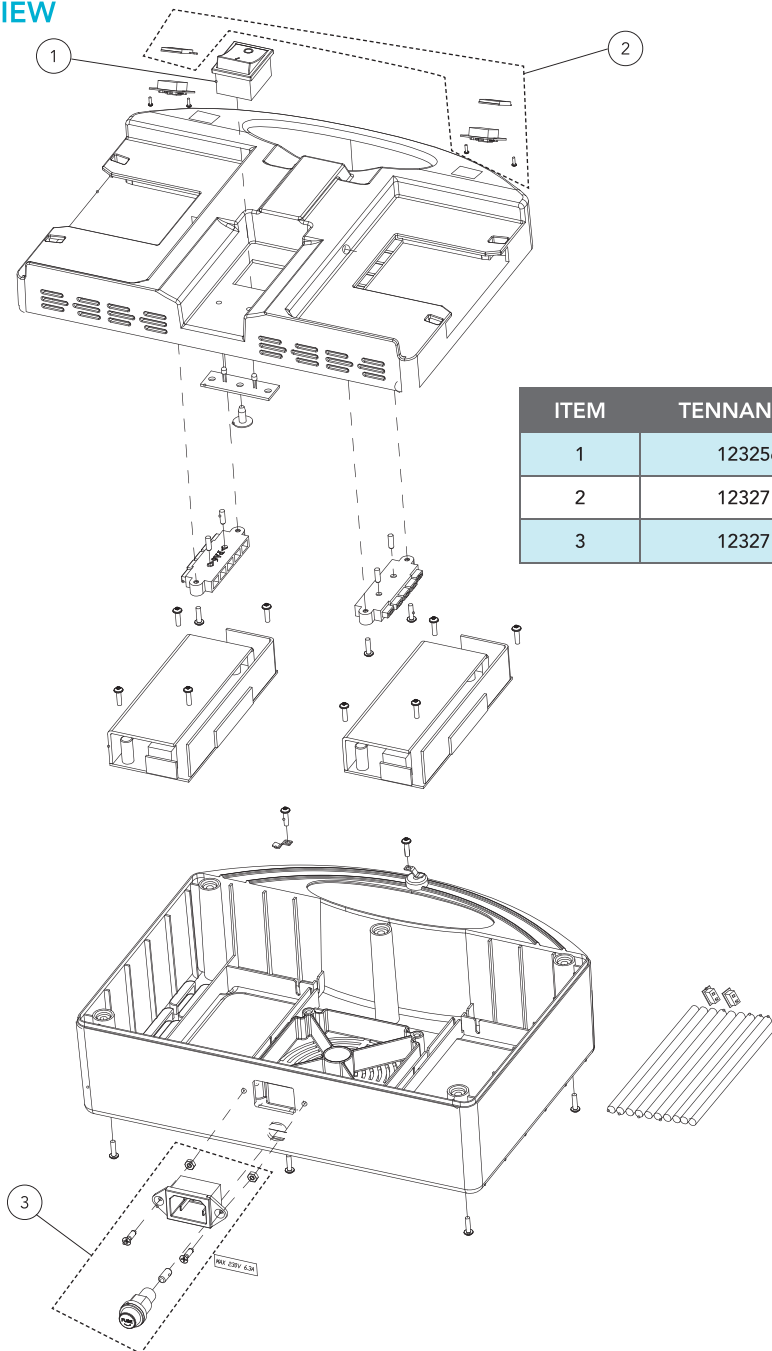

ITEM	TENNANT P/N	DESCRIPTION	QTY
1	1232564	SWITCH (ON/OFF)	1
2	1232712	VOLTAGE DISPLAY KIT	1
3	1232713	RECEPTACLE ASSEMBLY KIT	1



Tel: 1-800-553-8033